

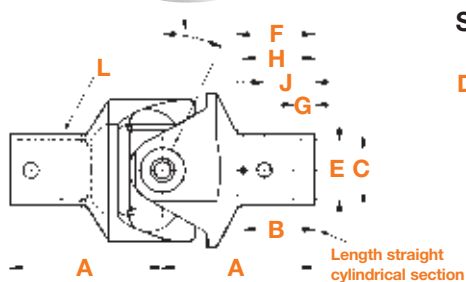

- Ideal for high capacity, critical applications
- Hand-assembled needles eliminate torsional free-play/“Backlash”
- Designed for continuous duty
- Available in single, double and telescopic designs
- Midget grease fittings in hubs allow field lubrication
- Elastomeric cover optional for harsh environments
- Ideal for applications over 2000 rpms
- Meet performance requirements of SAE AS39631
- Operating angles up to 25 degrees
- Shaft/hub configurations designed to meet your application needs

**Bored Hub**

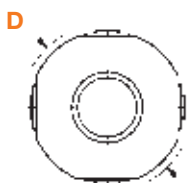

**Spline Hub**

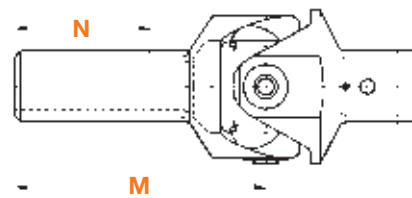
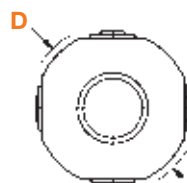

Bored Hub	A		B		C		D		E		F		G		H		J		L		Weight Max.	Static Torque Max.		
	in	mm	in	mm	in	mm	in	mm	in	mm	in	mm	in	mm	in	mm	in	mm	in	mm			Lbs.	kg
Part Number																								

**Dimensions and Specifications: Bored Hub**

12A-100	1.593	40.46	0.750	19.05	0.745	18.92	1.688	42.86	0.625	15.88	0.813	20.64	0.219	5.56	0.755-19.18-0.750	19.05	0.531	13.49	0.156	3.97	0.520	0.236	1500	169.5
20A-1447*	1.938	49.23	1.125	28.58	1.245	31.62	1.750	44.45	1.062	26.97	1.063	26.99	0.312	7.92	1.005-25.53-1.000	25.40	0.688	17.48	0.219	5.56	0.800	0.362	7500	847.5

\* Supercedes MS-24312

Spline Hub	M		N		Weight Joint Total Max.		Static Torque Max.		16/32 Diameter Pitch External Involute Spline Data		
	in.	mm	in.	mm	Lbs.	kg	Lbs.-in	N-m	Number Teeth	Pitch Dia. Ref	
Part Number										in.	mm
12A-101	2.656	67.46	1.438	36.51	0.57	0.259	1500	169.5	11	0.688	17.46
20A-1448**	3.312	84.12	2.000	50.80	1.20	0.544	7500	847.5	15	0.938	23.81

**Dimensions and Specifications: Spline Hub (For Bored Hub End See Table Above A thru L)**

\*\*Supercedes MS-24314